

**NOCCHI**

**LENNTECH**

info@lennotech.com Tel. +31-152-610-900

www.lennotech.com Fax. +31-152-616-289

INNOVATION

---

# **NOCCHI** DOMINATOR 4 PLUS





# WATER ENERGY

## WE PUT ENERGY INTO YOUR WATER

Founded in 1977, Nocchi is now part of the Pentair Group. For over 30 years now we have worked in the design and manufacture of pumps for water handling, providing our clients with quality products and practical solutions to meet all types of demand. The wide range of Nocchi products offers design studios and specialist distributors of hydraulic and sanitary/heating fittings all the products and systems to meet the needs of water supply and pressure booster systems for residential, public, irrigation and industrial applications.

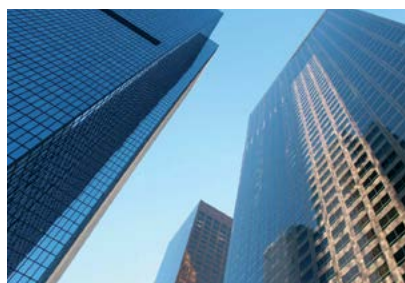

### **FIRE FIGHTING AND PRESSURE BOOSTER SYSTEMS**

Vertical and horizontal centrifugal pumps. Complete systems for the transfer and pressurization of water. Fire fighting units.



### **ELECTRIC PUMPS FOR RESIDENTIAL USE**

Submersible pumps, self-priming pumps, multi-stage centrifugal pumps and compact pumping systems for water supply to private homes, garden irrigation and rainwater collection systems.



### **ELECTRIC PUMPS FOR DRAINAGE**

Pumps for the transfer of clear water, waste water, sewage water and sludge. Pumps designed for numerous applications (basin water, cistern water, pumping stations, etc.).



### **ELECTRIC PUMPS FOR OPEN AND DRILLED WELLS**

Submersible pumps for irrigation and underground water pumping.

# PENTAIR WATER ITALY: THE PISA FACILITIES BECOME 100% GREEN.



Thanks to the installation of a sophisticated photovoltaic system installed on the roof of the building, the Pisa facilities have now become the first green Pentair site, able to

produce **100% of the energy required for production needs.**

4100 solar panels are installed on a surface area of 11,000 m<sup>2</sup>, capable of generating up to **1,280,000 kWh** per year.

Among the main advantages is a reduction in CO<sub>2</sub> emissions of **678,400 kg.**

Our clients now have the guarantee that Pentair products from the Pisa facilities are produced entirely using renewable energy.

The significant results achieved from the installation of these solar panels can be seen in real time, on the various displays fitted on the premises.

In fact, each activity performed in the Pisa facilities is constantly improved in

light of the maximum energy savings and minimal environmental impact on this site.

In view of the initiatives taken and future projects, we can now without a doubt affirm that Pentair is an authentic leader in production management, with the objectives of:

- Maximum respect for the environment
- Maximum energy savings
- Increased safety for personnel
- Maximum respect for health

# NOCCHI DOMINATOR 4 PLUS

## ELECTRIC SUBMERSIBLE MULTI-STAGE CENTRIFUGAL PUMP FOR FRESH WATER Ø 4"



DOUBLE MECHANICAL SEAL, HYDRAULIC SYSTEM PARTICULARLY RESISTANT TO SAND CORROSION, INTEGRATED CHECK VALVE

DOMINATOR 4 PLUS submersible pumps with double mechanical seal are ready to use in traditional wells, water deposits, collection tanks, fresh water courses, lakes etc. Supplied with nylon suspension cord (20 m).

### APPLICATIONS

- Lifting from traditional wells.
- Installations in tanks in the home for pressurization systems.
- Small automatic garden irrigation systems.
- Gravity irrigation systems.

### USAGE LIMITATIONS

- Type of liquid: clean water without suspended solids or abrasive material.
- Maximum liquid temperature: 40°C.
- Maximum immersion below water level: 17 m.

### MOTOR

- Dry motor with stainless steel body cooled by pumped liquid.
- Protection rating IP 68.
- Insulation class F.
- Single phase power supply with permanently activated capacitor.
- Thermal cutout protection incorporated in motor winding.
- Fully insulated cable connection chamber.
- Self-lubricating ball bearings.
- Rotation speed 2850 rpm.
- Suitable for continuous duty.

**NEWS 2015**  
PENTAIR



### TABLE OF MATERIALS

Components	Materials
1 Check valve	Thermoplastic with NBR o-ring - integrated
2 Pump body	Stainless steel Europe: EN10088-1 X 5 CrNi 1810 (1.4301) Usa: AISI 304
3 Mechanical seal - stationary part oil chamber	Aluminium oxide / NBR
4 Mechanical seal - rotary part oil chamber	Stainless steel Europe: EN10088-1 X 5 CrNi 1810 (1.4301) Usa: AISI 304 / NBR / Carbon graphite resin impregnated
5 Mechanical seal - stationary part	Aluminium oxide / NBR
6 Mechanical seal - rotary part	Stainless steel Europe: EN10088-1 X 2 CrNiMo 17-12-2 (1.4404) USA: AISI 316 / NBR / Carbon graphite
7 Motor shaft	Wet side - Europe: EN10088-1 X 8 CrNiS 18-9 (1.4305) USA: AISI 303/ Motor side - carbon steel
8 Diffuser cap	Polycarbonate with stainless steel wear insert Europe: EN10088-1 X 5 CrNi 1810 Usa: AISI 304 (1.4301)
9 Diffuser	Polycarbonate with ceramic wear insert
10 Impeller	Acetal resin
11 Bushing	Stainless steel Europe: EN10088-1 X 8 CrNiS 18-9 (1.4305) USA: AISI 303 with ceramic coating
12 Bearing	Self lubricating Nylatron®
13 Suction filter	Stainless steel Europe: EN10088-1 X 6 Cr 17 (1.4016) USA: AISI 430
14 Base	PPO - Noryl™ GFN 2
- Power cable	Type H07 RN-F - length 20 m
-	Thrust ring inserted in each stage

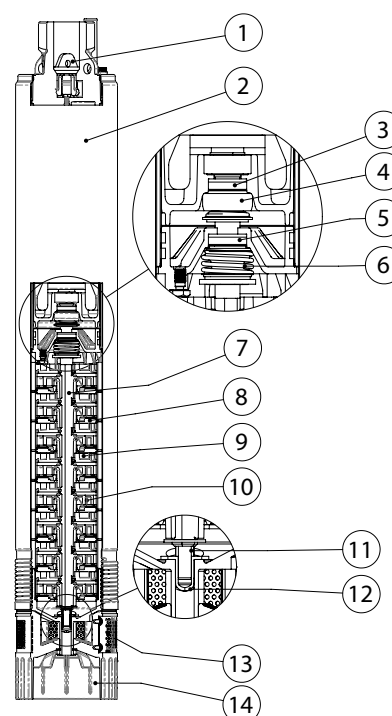

# NOCCHI DOMINATOR 4 PLUS

ELECTRIC SUBMERSIBLE MULTI-STAGE CENTRIFUGAL PUMP FOR FRESH WATER Ø 4"

## HYDRAULIC PERFORMANCE

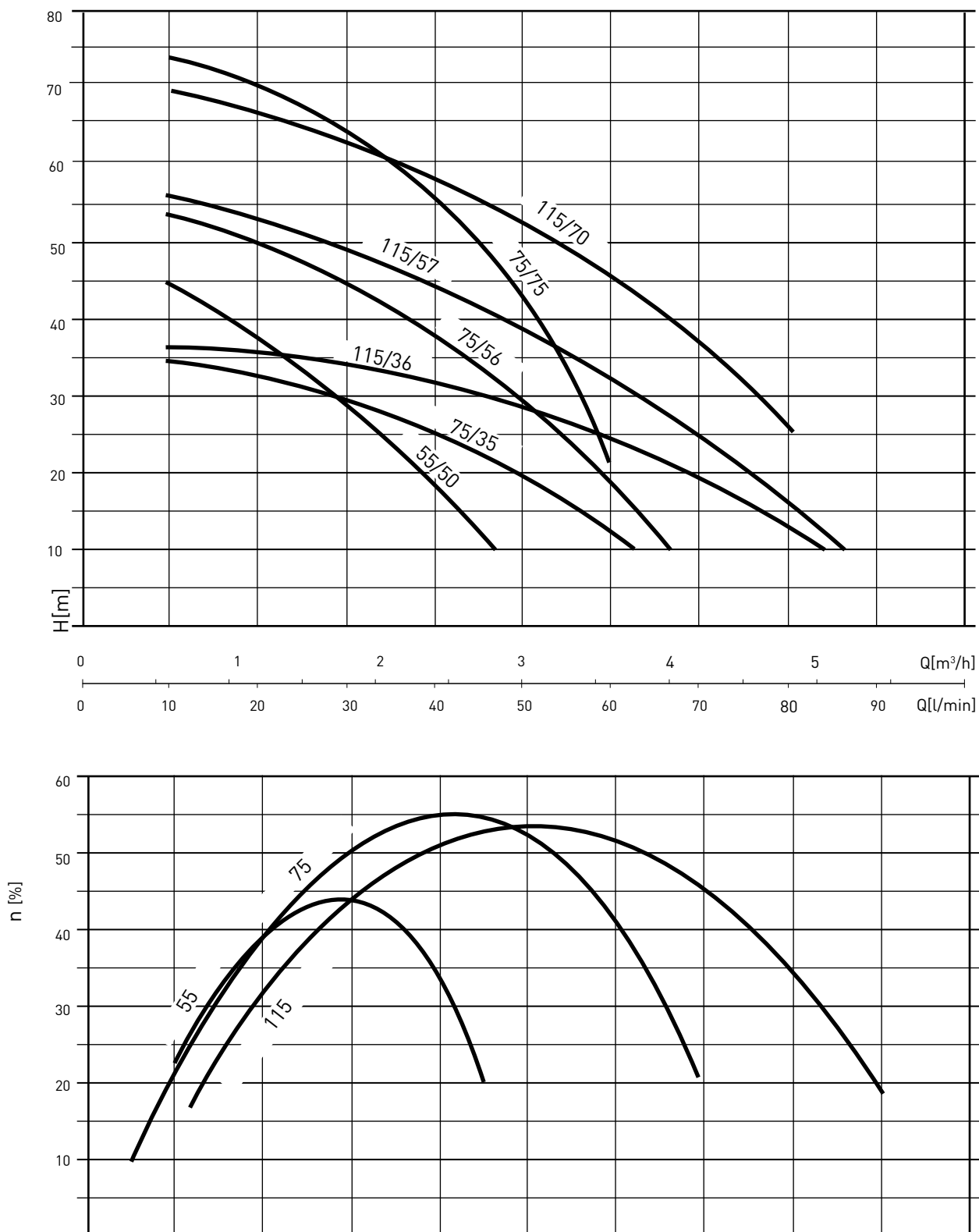

MEI ≥ 0.4 - MEI reference ≥ 0.70 - The reference efficiency information is available on the website: [www.europump.org/efficiencycharts](http://www.europump.org/efficiencycharts)



# NOCCHI DOMINATOR 4 PLUS

## ELECTRIC SUBMERSIBLE MULTI-STAGE CENTRIFUGAL PUMP FOR FRESH WATER Ø 4"

PERFORMANCE TABLE

MODEL	Motor output (P2)		Power Motor (P1)		VOLTAGE (V)	In (A)	µF	Stages	Q	l/min	0	20	40	60	80
	HP	kW	HP	kW						m³/h	0	1.2	2.4	3.6	4.8
DOMINATOR 4 PLUS 55/50 M	0.75	0.56	1.1	0.8	1 ~ 230	3.8	16	6	m.c.a. / m.w.c.	50	38.7	17			
DOMINATOR 4 PLUS 75/35 M	0.50	0.35	0.80	0.60	1 ~ 230	3	12.5	5		35	33	26	11		
DOMINATOR 4 PLUS 75/56 M	0.80	0.60	1	0.75	1 ~ 230	3.3	16	8		56	48.9	38.1	19		
DOMINATOR 4 PLUS 75/75 M	0.95	0.7	1.5	1.1	1 ~ 230	5	20	11		75	70	53	21.6		
DOMINATOR 4 PLUS 115/36 M	0.55	0.40	1	0.75	1 ~ 230	3.5	12.5	5		36	35	32	25	13	
DOMINATOR 4 PLUS 115/57 M	1	0.8	1.50	1.10	1 ~ 230	5	16	8		57	52	44.4	31.5	16.6	
DOMINATOR 4 PLUS 115/70 M	1.1	0.8	1.8	1.3	1 ~ 230	6	20	10		70	65	59	45.4	27	

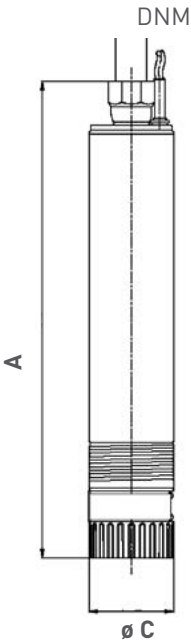

OVERALL DIMENSIONS AND WEIGHTS

MODEL	Dimensions (mm)				Weight (kg)
	A	Ø C	Free clearance	DNM	
DOMINATOR 4 PLUS 55/50 M	549	98	2 mm	1"1/4	10.4
DOMINATOR 4 PLUS 75/35 M	560	98	2 mm	1"1/4	10.2
DOMINATOR 4 PLUS 75/56 M	643	98	2 mm	1"1/4	10.8
DOMINATOR 4 PLUS 75/75 M	760	98	2 mm	1"1/4	12.5
DOMINATOR 4 PLUS 115/36 M	560	98	2 mm	1"1/4	10.2
DOMINATOR 4 PLUS 115/57 M	643	98	2 mm	1"1/4	10.8
DOMINATOR 4 PLUS 115/70 M	732	98	2 mm	1"1/4	12.5



INSPIRED SOLUTIONS FOR A CHANGING WORLD

**Discover** solutions to improve the products with the experience and the knowledge of our customers and sales team

Continuous **Development** with our engineer team using the most advanced technology in order to develop products respecting the environment

**Deploy** a whole range of products able to grant all possible pumping solutions for every application

Technical data subject to change without notice. PENTAIR WATER ITALY reserves the right to carry out modifications to its products at any time without having to provide prior notice.



**NOCCHI**

Pentair Water Italy  
Via Masaccio, 13 56010 LUGNANO (PI) - ITALY

All Pentair trademarks and logos are owned by Pentair, inc. All other brand or product names are trademarks or registered marks of their respective owners. Because we are continuously improving our products and services, Pentair reserves the right to change specifications without prior notice.

Pentair is an equal opportunity employer.

NO CODE Rev. 0 1/15 © 2013 Pentair, Inc. All Rights Reserved.

**LENNTECH**

info@lennotech.com Tel. +31-152-610-900

www.lennotech.com Fax. +31-152-616-289